

The information contained in this drawing is the sole property of CWS Coil Winding Specialist. Any reproduction in part or whole without written permission of CWS Coil Winding Specialist is prohibited.

REVISION HISTORY			
REV	ECN	DESCRIPTION	SIGN & DATE
A		PRODUCTION RELEASE	TKK 2/08/04 JLUU 2/9/04

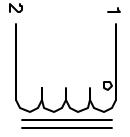

SCHEMATIC

6 USING A PERMANENT MARKING METHOD MARK PART NUMBER AND REVISION, IF APPLICABLE IF NEEDED, WRAP INDUCTOR WITH GLASS TAPE TO THE CORE  
MUST REST FLAT ON PCB. LEADS MUST BE TANGENT FLUSH WITH THE COIL EDGE. AS SHOWN (I.E. COIL REMOVE INSULATION AND TIN LEADS 0.5 INCH

5 WIND COILS EVENLY SPACED AROUND THE CORE CONSTRUCTION:

4 HI-POT TEST FOR WINDING TO CORE ISOLATION = 500VDC MIN CURRENT RATING : 2.4 AMPS, 40 °C TEMP. RISE, NO AIR FLOW DCR = 100.0 MILLI-OHMS MAX.

3 DC BIASED = 2.4 AMPS, INDUCTANCE = 96 UH  
DC BIASED = 1.8 AMPS, INDUCTANCE = 120 UH  
INDUCTANCE = 150 UH +-10% @ LOW DC BIAS, 1 KHZ, 250mV SPECIFICATIONS:

2 WIRE: UL RECOGNIZED 200°C RATED MAGNET WIRE  
CWS BYTE-MARK OR OTHER APPROVED PART  
CORE: COATED HIGH FLUX TOROIDAL CORE

1 RATING CLASS B (130°C MIN.) REQUIRED  
MATERIAL: UL RECOGNIZED 94V-0 FOR FLAMMABILITY  
NOTES: TOROIDAL POWER CHOKE. ALL DIMENSIONS IN INCHES

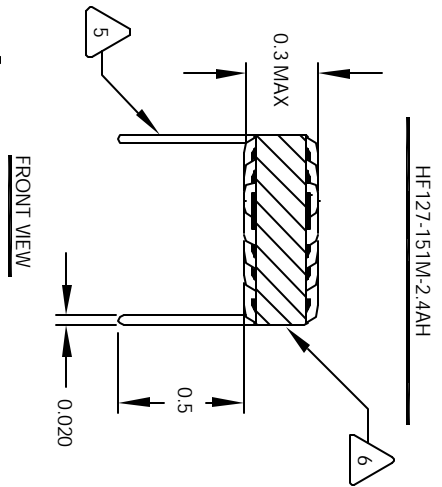

HF127-151M-2.4AH

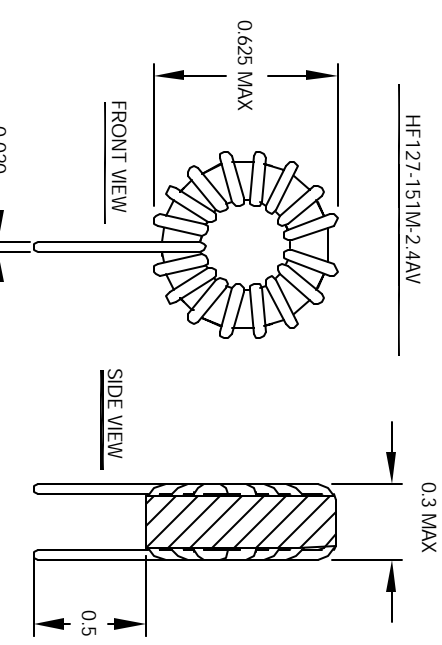

HF127-151M-2.4AV

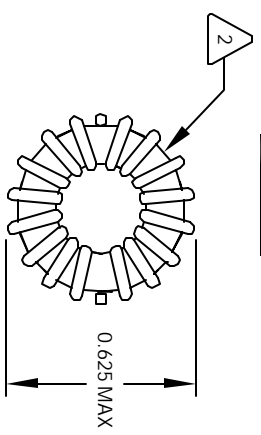

BOTTOM VIEW

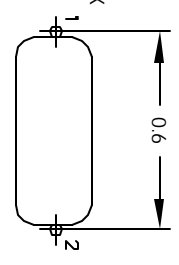

MOUNTING HOLES PATTERN

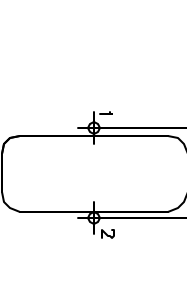

MOUNTING HOLES PATTERN

CODE IDENT	MFG. P/N	DESCRIPTION	ITEM NO.
PARTS LIST			
AUTOCAD SOLIDWORKS SIGN	X	CWS Coil Winding Specialist www.cwswind.com	
DATE	DATE		
2/8/04	2/8/04		
2/9/04	2/9/04		
3/8/04	3/8/04		
JLUU	JLUU		
TITLE:		Toroidal Power Chokes	
SIZE:		HF127-151M-2.4A	REV B
SCALE:		2=1	REV B